

EXTERNAL PERSPECTIVE & EXPLODED AXO

- 1. GABION WALL / ROOF CONSTRUCTION
- 2. STEEL FRAME SUPPORT FOR ROOF
- 3. INTERNAL SEATING
- 4. PERMEABLE PAVING
- 5. RAIN GARDEN CONFIGURATION

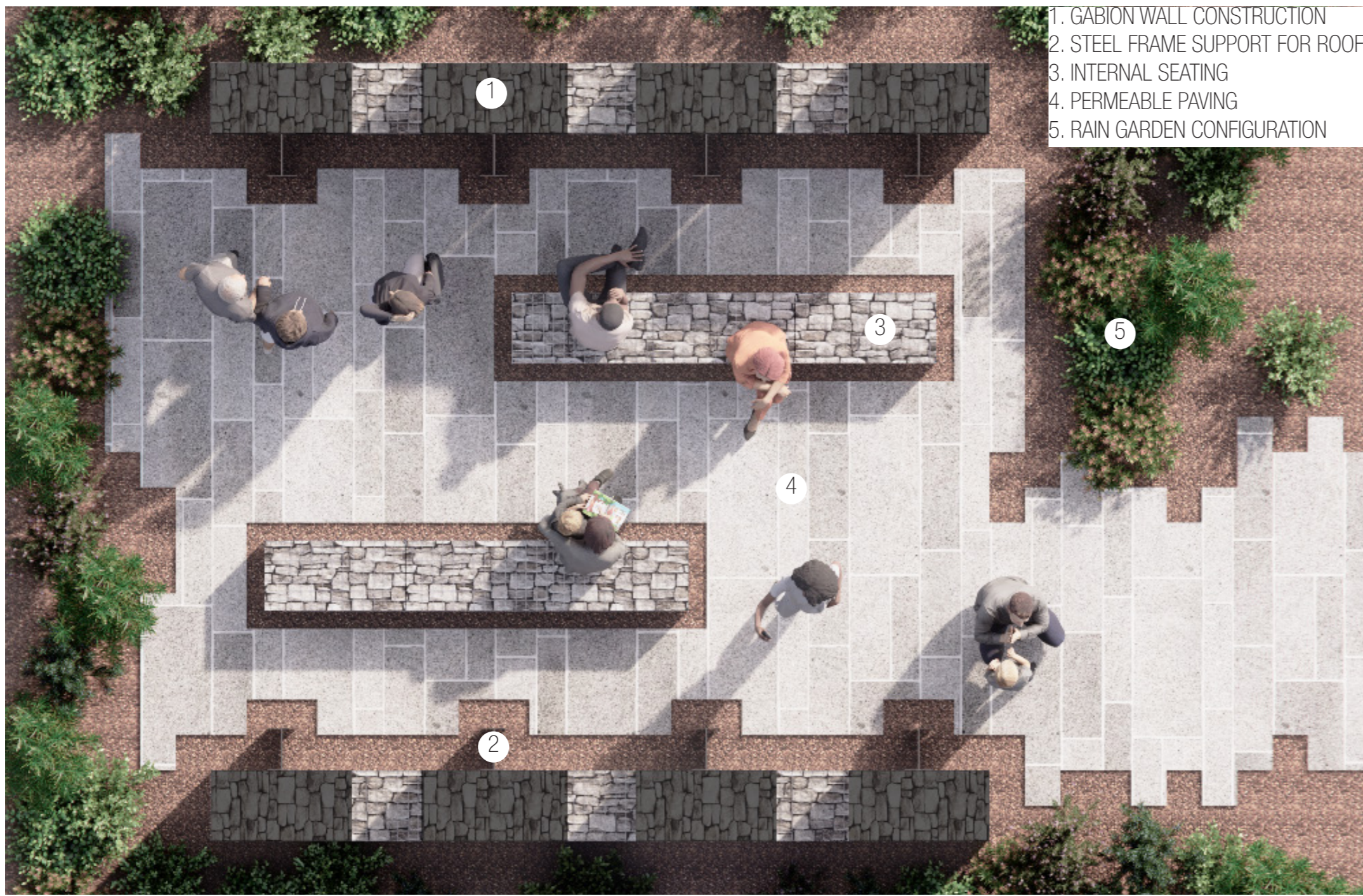

PLAN VIEW



SECTIONAL PERSPECTIVE

- 1. GABION WALL / ROOF CONSTRUCTION
- 2. STEEL FRAME SUPPORT FOR ROOF
- 3. INTERNAL SEATING
- 4. PERMEABLE PAVING
- 5. RAIN GARDEN CONFIGURATION
- 6. CONCRETE STRIP FOUNDATION



ENTRANT NUMBER: 132

Travelling Water Pavilion

The purpose of the Travelling Water Pavilion is to re-embrace the traditional characteristics of the movement of water before the influence of the concrete jungles of today's cities and towns through the use of passive water attenuation.

Due to the effects of extreme weather and the way buildings have been constructed, the flow of water is direct and fast resulting in increased run-off due to impermeable surfaces and pressure on drainage infrastructure due to existing capacity being exceeded causing flooding that can lead to dangers to the community through property damage, injury and death.

The Concept for the pavilion is taking the section of the simple house and develop the envelop to provide a permeable barrier that encourages water flow to be more organic and indirect from falling as rain on the roof and filtering through into the ground via the walls and floor (via gabion wall construction).

Additionally the outside perimeter of the pavilion will have planting and shrubs on bark mulch forming a rain garden further encouraging passive drainage of rainwater.